

Is this building just a church in another guise?

Yes, and no. A church has traditionally been seen only as a place for religious activities. We now see that differently, the church should be much more. Therefore, **Community Life Centre** will provide far more facilities than a church alone could possibly offer. The church will be incorporated within the building as this is an important aspect of the community for many people.

Will it bring more problems to the Oval?

As mentioned in a previous answer, many of the problems we face on The Oval are due to a lack of facilities and activities. **Community Life Centre** will meet this need and will also create a safe environment for people of all ages to join together.

When will it open?

Once we have secured the funding that is needed to move forward with the centre, we anticipate it taking approximately 18 months in total to demolish the old building and then build **Community Life Centre**.

Is this really going to happen?

We are extremely serious about **Community Life Centre** and a huge amount of time and effort has already been given to the project. The involvement of the local community is essential and together - **WE CAN MAKE IT HAPPEN.**

How can I help?

We need your help in many ways.

- You may want to help shape **Community Life Centre** by being part of a steering group.
- You may have some great ideas for fundraising within the community.
- You may have some suggestions for activities to take place within the centre, or even better, you might want to lead an activity.

The contribution you make will bring about a centre that we can all feel proud to be a part of.

If you would like to help or simply want some more information about the project please contact:

by letter to **Community of Christ**
1a Jubilee Buildings Outram Street Sutton in Ashfield NG17 1DE

by e-mail to: **wayne@cofchristsutton.org.uk**



Vision of the Future

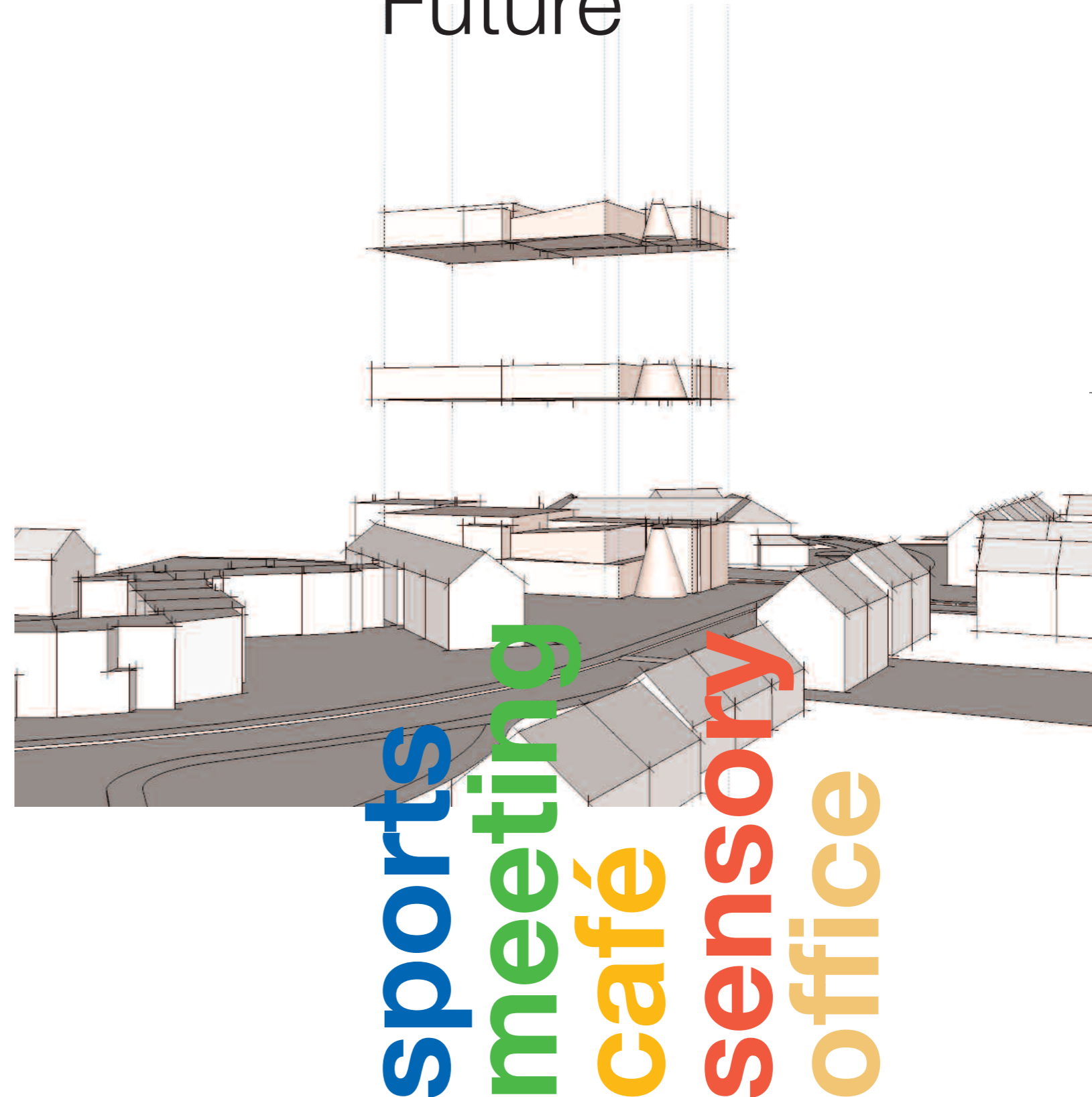

Introduction

The church on the Oval has been a part of the Carsic community for almost 40 years organising youth groups, guardian & toddler groups, drop-in mornings and many other such activities.

Over the last few years the church has been developing plans to provide more facilities for the community to use. A neighbourhood survey was carried out in 2003. The outcome of this was the need for a building for the community to use for sporting activities, a drop-in café and an information/advice centre.

The Vision

Community Life Centre will provide

- a focal point for community activity
- support and activities for the community whatever age or gender
- a centre of which the community can be proud – meeting their needs
- leisure, recreation and social facilities

Where are we now?

We are making it happen!

- Community survey undertaken
- Feasibility study finished
- Architect appointed
- Initial plans drawn
- Fund raising is underway

What happens next?

- Continue fund raising
- Increase the involvement of the community in the project
- Detailed building design undertaken
- Local authority planning permission to be obtained
- Choose the builders
- Demolish the existing building
- Build **Community Life Centre**



The existing Church on the Oval



The Plan

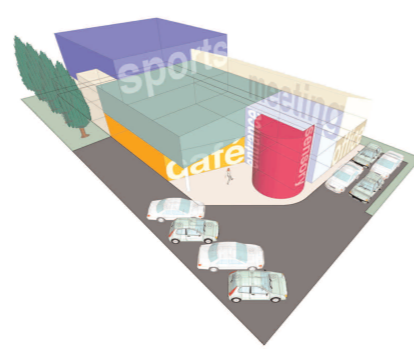

The Vision

Questions and Answers

Who will benefit from these facilities?

Community Life Centre will benefit people of all ages and backgrounds, from those who simply want a place to meet with others or have a snack in the café, to those who want a place to play sports or use computers to improve their skills. We would like to think that there will be something for everyone. Our vision is that **Community Life Centre** will be at the heart of the Carsic neighbourhood.

How much will it cost and where will the money come from to make it happen?

The total cost of the project is estimated at £2m. There are numerous funds available to assist in financing a project of this nature and it is our intention to apply for these. It won't be easy, but it is certainly achievable.

How will our neighbourhood be improved?

Not all neighbourhoods are perfect and Carsic has its share of problems and difficulties.

We believe this is partly due to a lack of resources, opportunities, facilities and activities within the area.

Community Life Centre will go some way to resolve many of these issues and is part of the solution.

As a result, it will improve our life in this neighbourhood and will encourage us to feel proud of the community in which we live.

How will CLC be managed?

Community Life Centre will be created as a separate charitable organisation and will be managed by local members of the community along with user groups and the church. Together, we will organise the running of the centre which may consist of some paid staff along with local volunteers.

sports
meeting
café
sensory
office